

THIN BRICK *by Owensboro*

www.thinbrickbyowensboro.com

THIN BRICK

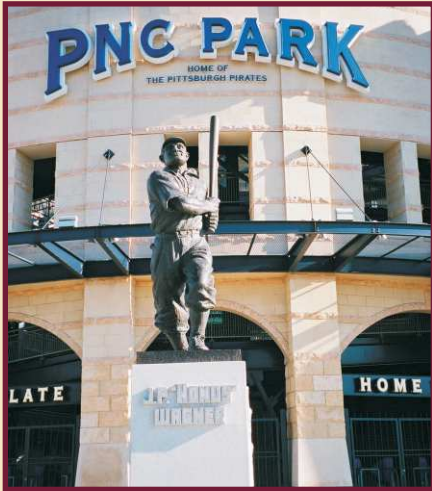

Pittsburgh Pirates - PNC Park



Burger King



Harley Davidson

Crafting quality thin brick, panel brick and full size brick, and delivering it with unsurpassed customer service, have been the hallmarks of our 50+ year history in the brick manufacturing business.

We are proud Thin Brick by Owensboro has been specified and used on high profile projects throughout the US. Renowned retail companies such as Burger King, American Eagle, Barnes & Noble, Urban Outfitters, The Gap, ShopRite, Harley Davidson, CVS Pharmacy, Pizza Hut, Tumbleweed and Krystal Restaurants have successfully integrated our thin brick products into their building designs.

PANEL BRICK



Gibson Guitar Store

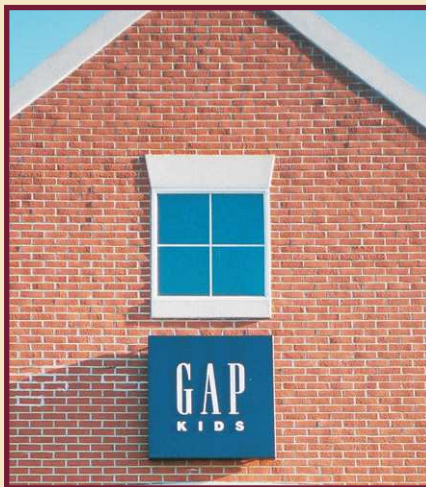

The Gap

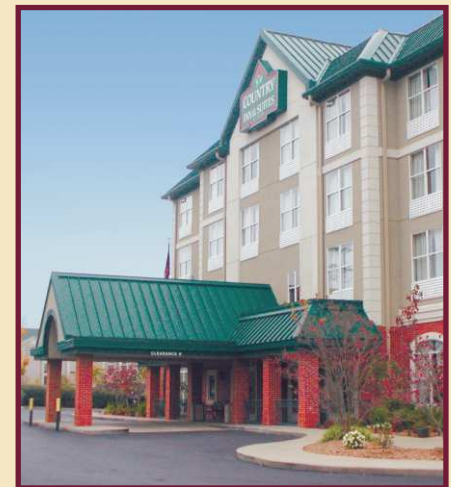

Country Inn & Suites

Thin Brick by Owensboro | P.O. Box 907 | Owensboro, Kentucky 42302 | 270-684-7268 | 270-685-5128

THIN BRICK *by Owensboro*

THIN BRICK

Value

Versatile. Light weight. Easy-to-install. What's not to like about Thin Brick by Owensboro?

The Original Thin Brick

Our Thin Bricks are kiln-fired from rich Kentucky clay like our full size brick to achieve the look and feel of standard brick. The difference is that at 1/2-inch thick, they are only 1/6 the thickness of standard bricks. Because they are so thin and lightweight, they offer endless possibilities for all types of applications.

By combining intense heat with an airtight environment, our kilns produce well-fired bricks that meet or exceed ASTM-C1088 standards. Our kilns feature an advanced flashing process that delivers the wide range of the colors you want for all types of interior and exterior applications.

Structures built with other siding products such as wood, vinyl or aluminum may not have the footings, foundations or lintels to accommodate full brick masonry. Thin Brick by Owensboro requires no special foundations, supports or footings so they can be applied where full size brick cannot.

Economical Elegance

Thin Brick by Owensboro is made from select clays and shale that are chosen for their fired strength, purity and lasting beauty. They are more economical than standard brick because they cost less to produce and are easier to install resulting in shorter construction schedules.



THIN BRICK (Flat)

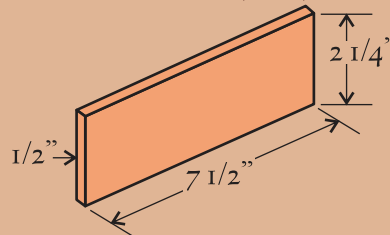

THIN BRICK (Corner)

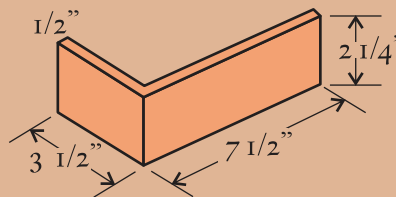

SIZE

Thin Brick	7 1/2" x 2 1/4" x 1/2" thick
Corners	2 1/4" x 3 1/2" x 7 1/2" x 1/2" thick

COVERAGE

Thin Brick	7.0 pieces per square foot
Corners	4.5 pieces per linear foot

WEIGHT

Thin Brick	.7 lbs. per piece
Corners	.95 lbs. per piece

PACKAGING

Thin Brick	40 per box; 100 boxes per pallet
Corners	18 per box; 100 boxes per pallet

MORTAR

Mortar	One 80 lb. bag covers approximately 50 square feet of wall space.
--------	---

Install

Creating a Beautiful, Rich Look Was Never Easier

Our Thin Brick is ideal for individual installation on a variety of interior surfaces such as walls, fireplaces and back splashes. The combination of their rich tones and ease of installation make them the perfect fit for just about any interior project.

Our Thin Brick is Strategically Designed to be Compatible with Other Thin Brick Systems

We know there are some interior and exterior applications that may require using different brick systems.



Our Thin Brick is designed to be compatible with many other panel systems including Loxon, EZ Wall and FitZit.

Please email us if you have any questions about our Thin Brick compatibility with other thin brick systems.

Thin Brick by Owensboro | P.O. Box 907 | Owensboro, Kentucky 42302 | 270-684-7268 | 270-685-5128

PANEL BRICK

Install

Factory Assembled

Thin Brick by Owensboro panels are a factory-assembled system featuring genuine clay kiln 1/2-inch thin brick facing adhered to a rigid insulation fiber or cement board backer. Panel Brick weighs less than six pounds per square foot, which is 1/5 the weight of full size brick.

Thin Brick Veneer System

Panel Brick is a thin brick veneer system comprised of Thin Brick adhered in running bond to a 16" x 48" backer board.

Insulation Board

The rigid backer board used to create Panel Brick is a high density, nail base, asphalt impregnated fiberboard manufactured by Temple-Inland Corporation meeting Federal specification LLL-1-535B, Class E, Style 2 conforms to Industry Standards ANSI/AHA A194, 1-1985 Type IV, Class 2 and ASTM C-208-94.

Adhesives

An exterior, waterproof, synthetic rubber base adhesive that complies with APA specification AFG-01 is used to bond Thin Brick to the backer board.

Assembly And Installation

Installation of Panel Brick is a straight forward construction procedure for prefabricated thin brick systems. Panels are fastened to the supporting construction by driving fasteners into backing material using not less than two fasteners per square foot. A water resistive barrier shall be applied to the substrate behind the Panel Brick. Subsequent panel is interlocked with the first and so on. After all panels are installed, the masonry joints between the Thin Brick are mortared and finished. Panel Brick fabricated with cement backer board must be used where



panels are installed below grade to six inches above grade. Detailed installation procedures are available for download on our website.

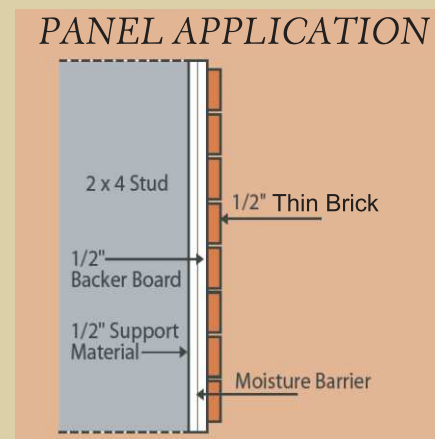

Fasteners

Fasteners must be suitable for the underlying material and of sufficient length to penetrate through the sheathing to insure adequate support for the panels meeting ASTM D-1037-93 testing. Panels shall be mechanically fastened with adequate fasteners to support horizontal and vertical dead loads. Fastener schedule is provided by the manufacturer.

Channels

The design of this Thin Brick veneer panel system requires the application of a 1" x 3" L channel installed below the bottom edge of the lower panel not to extend more than 3/8" below the bottom course of Thin Brick or the brick panel bottom. Channels, through wall flashings and approved vapor barriers,

will provide adequate system relief in accordance with ASTM E-514.

Mortaring

Over fill masonry joints with mortar after all panels have been set and all individual units have had adequate time for adhesive to set, using a tuck pointing tool, metal-tipped mortar bag kit or mortaring machine. Mortar should be a rich mixture of cement and masonry sand mixed to a consistency that flows smoothly through a grout bag. Finish masonry joints with a mortar into the masonry joints. Grout mix is available from the manufacturer. Grout mixture shall conform to ASTM C270.

Caulking

Thoroughly caulk all areas where Panel Brick meets non-Panel Brick surfaces and abutting material. Caulk must be a high performance sealant compatible for conditions and installed per caulk/sealant manufacturer's instructions.

SIZE

Panels 16" x 48" x 1" thick

COVERAGE

Panels 5.33 square feet per panel
Approximately 19 panels per square.
One square covers 100 square ft.

WEIGHT

Panels 28 lbs. per black board panel
40 lbs. per cement board panel

PACKAGING

Panels 91 panels per pallet (black board)
70 panels per pallet (cement board)

MORTAR

Mortar One 80 lb. bag covers approximately 50 square feet of wall space.

THIN BRICK *by Owensboro*

COLORS

Old World Look

THIN BRICK / PANEL BRICK



King William



Martingale



Sierra

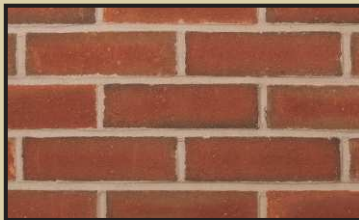

Flashed Martingale



Alpine



Greywood



Old Oakley



Old Lexington



Plantation



Springfield

TUMBLED THIN BRICK / PANEL BRICK



Allentown Tumbled



Sierra Tumbled

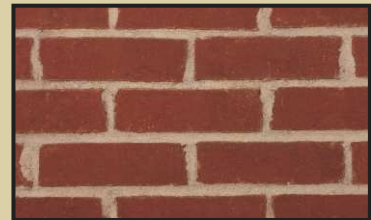

Flashed Martingale Tumbled



King William Tumbled



Greywood Tumbled

THIN BRICK *by Owensboro*

1120 Ewing Rd.
Owensboro, Kentucky 42301
270-684-7268 | 270-685-5128

www.thinbrickbyowensboro.com